

The Architectural Committee is committed to retaining a positive look and feel in the community. When it comes to placement of a storage shed or other structure in the community, including your yard, the committee will look at the following aspects of your request in making its decision to approve or decline the request:

Location: Placement within the yard

Dimensional size: Length, Width and Height

Material: Both wall and roof

Color: Both wall and roof

Visual Impact: What will it look like from other yards or the street and sidewalk.

To that end, we require this information as part of your request. In the below pages are two drawings, provided as examples of what we are looking for to assist us in determining the acceptability of your request. Please make sure you include a drawing of your project with your request. If you are requesting permission to place the shed between your house and the side wall/fence, please indicated in your drawing, the side wall of your neighbor's home. The purpose of this is to allow us to determine what, if any visual impact your placement will have on the community, which includes your neighbors.

SAMPLE SITED PLACEMENT

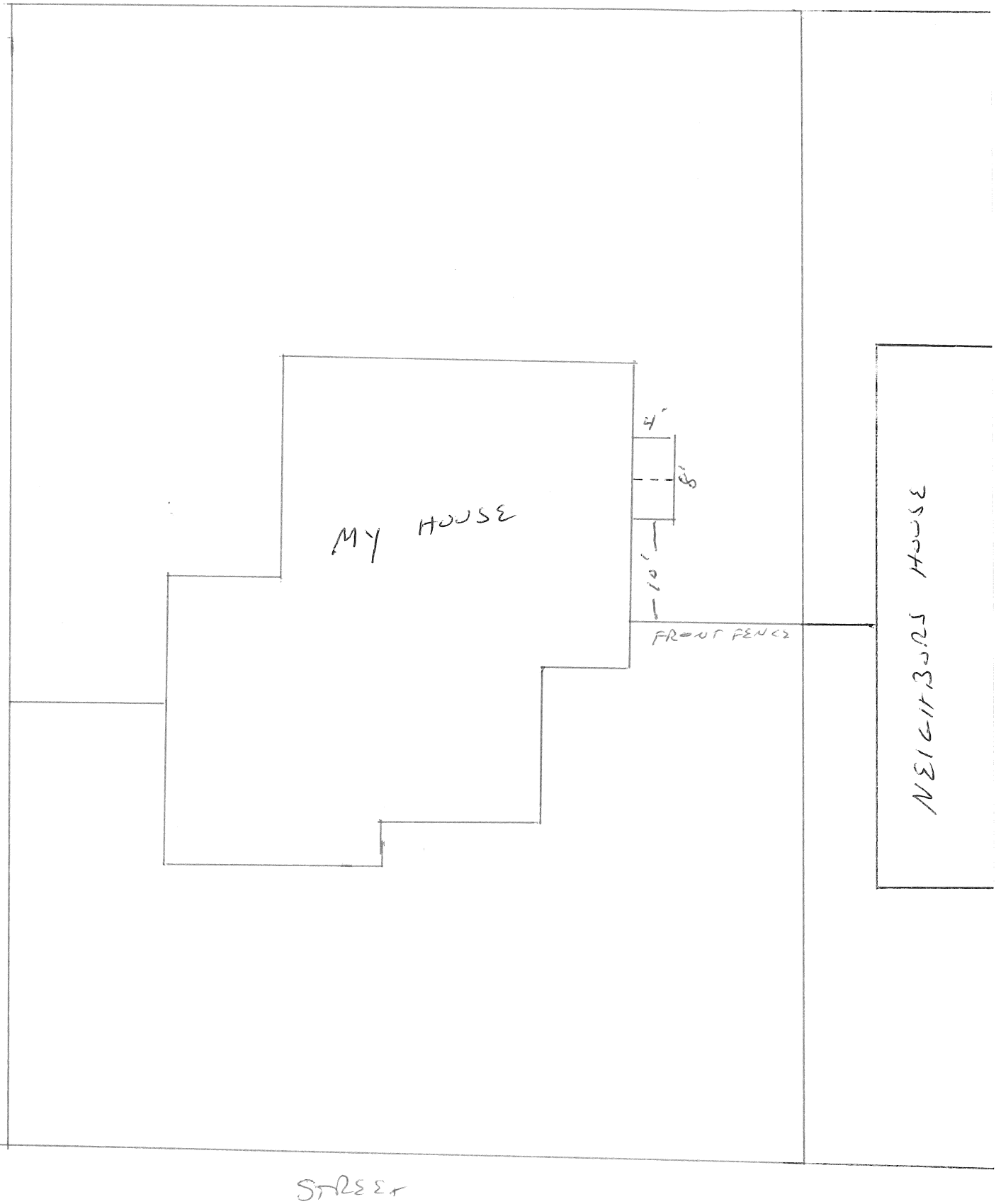

SAMPLE 'PROFILE VIEW'

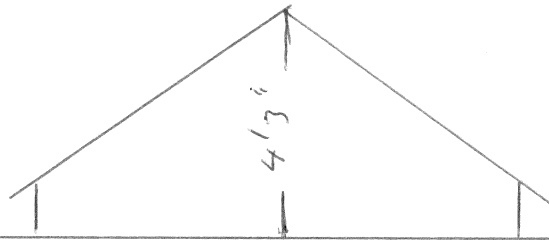

TOP OF FENCE

